

Sexual Transmitted Infections

Chlamydia & Gonorrhea Combo Test

Chlamydia —

The most common bacterial STI which is frequently asymptomatic. The leading preventable cause of infertility.

Gonorrhea —

Around half of women and one in ten men with genital gonorrhoea won't have any obvious signs or symptoms.

POCT Rapid Test
10 Minutes waiting

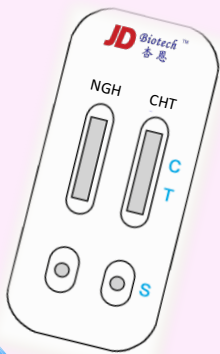

Sample Type:
SWAB

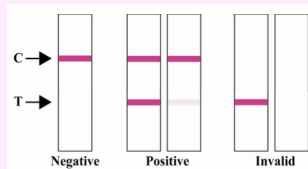

RISK GROUPS

Young People	Men who have sex with men (MSM)
History of a prior STI	Illicit drug use
Lower socioeconomic status, or high school education or less	Admission to correctional facility or juvenile detention center

Testing two of main bacterial STIs chlamydia, gonorrhoea at one time.

Sexual Transmitted Infections

Chlamydia & Gonorrhea Combo Test

Test Procedure

1

Remove the testing device from the sealed pouch by tearing at the notch. Then place the testing device on leveled surface. Label the

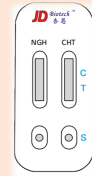

2

Place the swab into the micro tube. Add 6 drops (300µL) of specimen extraction buffer A on the swab and rotate swab.

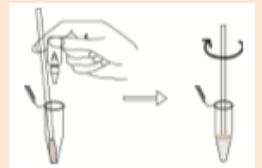

3

Add 4 drops (100µL) of the specimen extraction buffer B into the micro tube and rotate swab against the tube. Discard the swab into a disinfectant container.

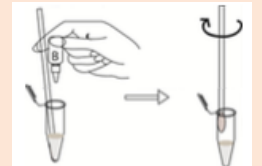

4

Mix the sample well by vortexing. Specimen collected should be stored at 4-8°C and tested within 24 hours.



5

Add three full drops (130 µl) of the specimen without air bubbles into the sample well that is marked with an arrow on the testing device.



6

Read the results in 10 minutes. Read results as shown under interpretation section.

NOTE: Strong positive specimens may produce positive results in as little as 1 minute. Confirm negatives in 10-20 minutes before interpreting the result.

**DO NOT
INTERPRET
RESULTS AFTER
10 MINUTES**

JEI DANIEL BIOTECH CORP

A201, Building 1, No.69, Hua Yang Road
Jinan Shandong
250100 China
Tel: +86 53182373551
Email: business@jdbiotech.com

JEI DANIEL BIOTECH CORP

4A26, No.5, Sec.5 Hsin Yi Road
Taipei
110 Taiwan
Tel: +886 2 27253734
Email: business@jdbiotech.com